

2. 形状及び寸法

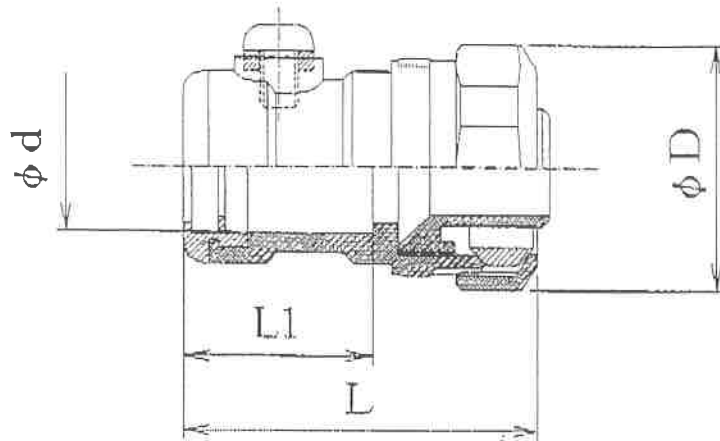

厚鋼用ライニング

/mm

—	$L \pm 0.5$	$L1 \pm 0.2$	$D \pm 0.2$	$d \pm 0.2$	重量 (g)
17-16	57.0	29.0	37.2	22.9	135.0
24-22	64.0	34.0	46.1	28.3	180.0
30-28	73.0	43.0	54.0	34.9	280.0
38-36	81.0	45.0	63.8	43.7	415.0
50-42	89.0	50.0	78.2	49.7	605.0
50-54	89.0	51.0	78.2	61.4	730.0
63-54	96.0	56.0	93.0	61.4	950.0
76-70	102.0	58.0	108.3	77.5	1135.0
83-82	117.0	58.0	121.5	89.9	1530.0
101-92	125.0	67.0	145.0	102.8	2360.0
101-104	131.0	75.0	145.0	115.5	2360.0